

2260 SHERMAN AVE. • NORTH BEND, OREGON 97459

## “S” SCALE 50’ BOXCAR

### BOX CAR PARTS

- |                           |                           |
|---------------------------|---------------------------|
| 1. Body                   | 11. Walk Corner Grabs (2) |
| 2. Roof                   | 12. Grab Irons (10)       |
| 3. Roofwalk               | 13. Tall Ladders (4)      |
| 4. Underframe             | 14. Brake Housing (High)  |
| 5. Brake Line             | 15. Brake Platform (High) |
| 6. Doors (2)              | 16. Platform Supports (2) |
| 7. Coupler Boxes (2)      | 17. Brake Wheel           |
| 8. Air Reservoir          | 18. Bell Crank            |
| 9. Triple Valve           | 19. Stirrup Steps (8)     |
| 10. Roofwalk Supports (4) | 20. Tack Boards           |

Detail parts included for modern era modelers, (not shown):

- |                      |                          |                        |
|----------------------|--------------------------|------------------------|
| 1. Short Ladders (8) | 2. Brake Housing (Short) | 3. Brake Platforms (2) |
|----------------------|--------------------------|------------------------|

## ASSEMBLY INSTRUCTIONS

### Tools Recommended:

Xacto Knife	Fine Clippers	Small File or Emery Board
Pin Vise	Small Drill Set	Tweezers or Needlenose Pliers
Liquid Plastic Cement and or ACC Cement		

Please read the instructions, study the drawing and parts before assembling. Many of the detail parts are very fine and delicate. The best way to remove them from the sprues is with a pair of fine clippers or Xacto knife. **DO NOT ATTEMPT TO BEND, TWIST, OR BREAK THE PARTS OFF!**

Before starting: A Comment; This kit has many detail parts, and it is up to you how many to use. We have tried to design the parts for easy fit, however you can have a very enjoyable car just using the basic parts.

- (1) Carefully cut the doors from the sprue. Due to the doors being close to scale in thickness, they are bowed out a little. This can be corrected easily by holding the door between two fingers and pushing in with your index finger on the middle of the door until it is bowed in slightly. Doing this for a few seconds, a couple of times should straighten the door out. Next slightly file or sand the top of the door until it fits nicely between the guides on the body. You may want to wait until assembly is complete before gluing to car.
- (2) Test fit the roof. If necessary sand the rib on the inside of the roof until the roof snaps in tightly. Modern era modelers, not using the roofwalk will skip the following step. Finish drilling the holes for the roofwalk, which are located on the inside of the roof. The holes will need to be slightly larger than the pins on the walk. Use a 3/32" or .120 drill. Glue the walk to the roof and set aside.
- (3) Carefully cut the underframe from the sprue, sand the edges of the bolster and ribs if necessary, test fit, study the drawing to make sure you have the underframe lined for proper direction to the hand brake end of the car, then glue to car. Next, VERY CAREFULLY cut the brake line from the sprue, especially around the brake unit. You may wish to glue the brake line on later, just before the trucks.

- (4) Detail Parts: Cut these parts with care from the sprues. Extra grab irons and steps are included. The holes should be a good fit so use small amounts of glue.

Ladders: Holes are not provided for the top pins, so that modelers using short ladders will not have to fill them. Notice that the ladders for the sides have two short pins at the top, while ladders for the ends have a long and a short pin. The long pin should be towards the corner of the car, with the short pin resting on the end rib. It may be necessary to trim the long pin a little for a good fit.

Grab Irons: Install side, end and roofwalk corner grab irons as the drawing shows. Use very small amounts of glue.

Handbrake: Very carefully cut the brake housing from the sprue as the long rod is very fragile. After cutting the brake platform, supports, brake wheel, and bell crank from the sprue, glue to end of car as drawing shows. Modern modelers may want to use the short, modern era brake housing and platform, however many cars, while receiving low or chopped ladders still retained the high brake assembly and high ladder next to it.

Stirrup Steps: Carefully cut the steps from the sprue. Notice, as the drawing shows: on the sides the straight steps are for the left, while the indented steps go to the right. Also note that the steps are glued to the inside of the side panels with the stirrup resting against the bottom of the panel. Make sure when installing that you have the steps facing outward, otherwise they will appear to be too far underneath the car side.

- (5) Glue on roof before adding the roofwalk end supports to the walk.
- (6) Now glue the Triple Valve, Air Reservoir and the brake line to the underframe.
- (7) Coupler Boxes: The boxes will accept Kadee "S" #802 couplers, however the bump must be removed from the coupler shank. Insert the coupler and spring onto the bottom lid with the tail down. Insert this assembly into the box top. It is a push fit into the bottom of the car. The pin should fit snugly into the hole. It may be desirable to glue the box to the car bottom.
- (8) Trucks: To glue journal lids on the trucks, a glue for Delrin plastic should be used. It will be easier to glue the lids while still attached to the sprue. Check the trucks, including the wheels, for any flash or sprue bumps that may need to be removed. Also, we suggest that you test the trucks before attaching the car bottom with the screws provided.
- (9) Finally, glue the tack boards and doors to the car in the position that you prefer.

That's it. We hope that you have enjoyed building this kit and will continue to have fun running or displaying it. We welcome your comments on this model kit and suggestions for future projects.

THANK YOU AND KEEP THOSE TRAINS ROLLIN'.

Note: If you find that a part is missing or defective, or if you should accidently break a part, please contact your dealer or write for a replacement.

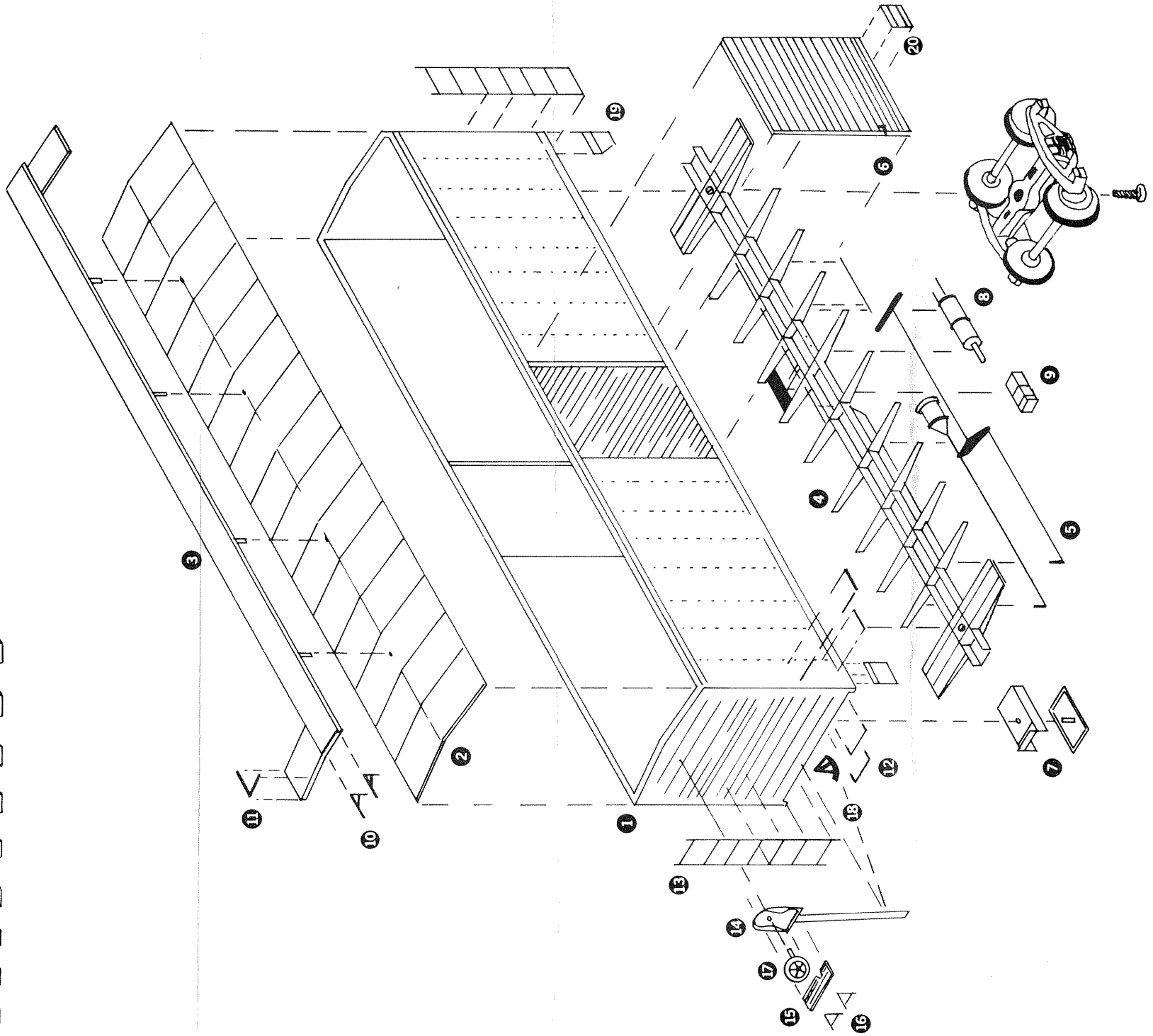
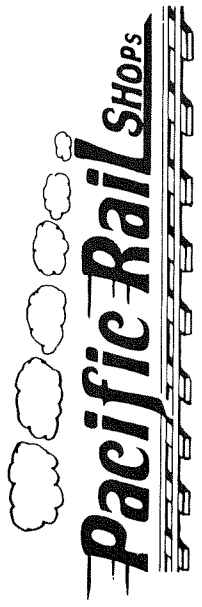



### CLASS B207 50' BOXCAR

Our model dating from 1955, is a 3rd or 4th generation car, originating from a 1942 AAR design. It is similar to previous generations from 1950, having improved dreadnaught ends and diagonal roof panels. Over 40 railroads had this car or very similar versions, some having welded sides. Improvement of the design continued on through the years, with a variety of door arrangements and dimensions.